

## Westminster Cathedral Millennium Cross

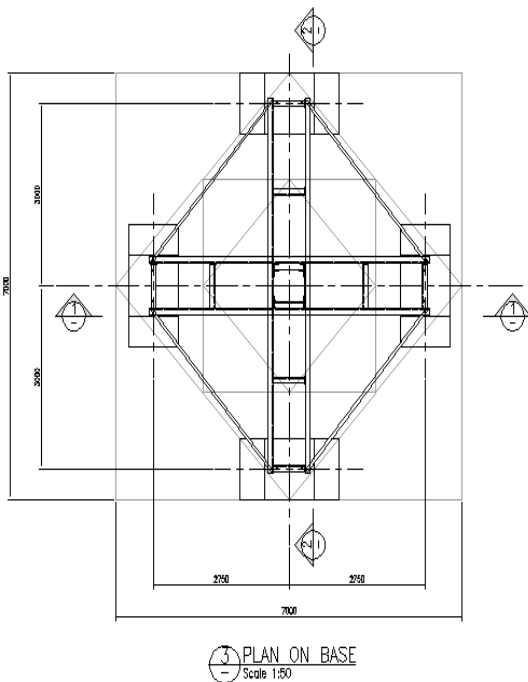
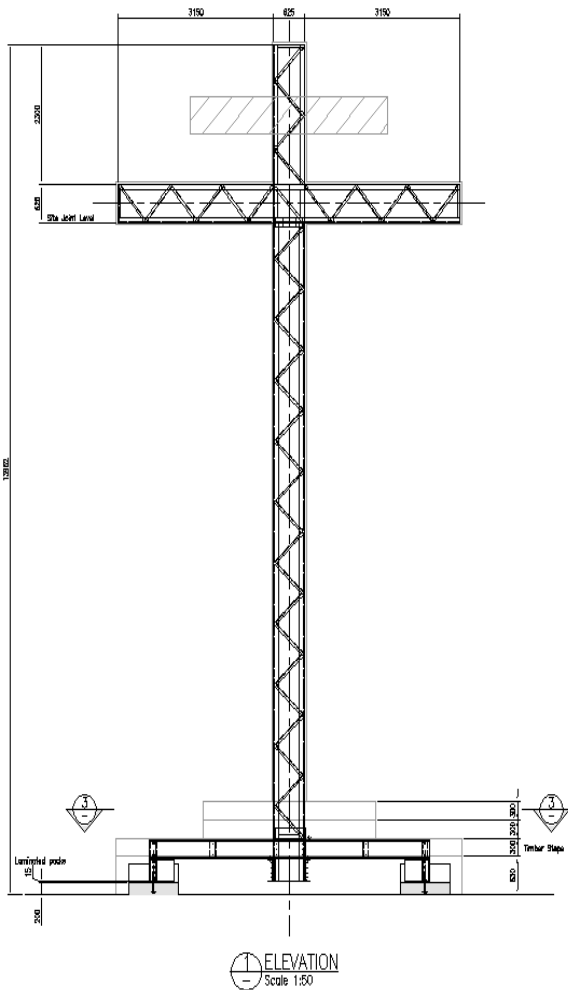

The Millennium Cross is a unique structure marking the start of the third millennium and the death of the Archbishop of Westminster Cardinal Basil Hume.

The timber clad cross has a steel lattice core supported on a steel grillage fixed to precast concrete foundation blocks.

The cross was temporarily situated at the entrance to Westminster Cathedral and then after two years was moved to its permanent position at Ampleforth Abbey, North Yorkshire. The structure was therefore designed for the much higher wind loads appropriate to its permanent site.

Melia Smith & Jones were commissioned by Harold Newsome Ltd, the steel fabricators, to design the structure and foundations for the cross. MSJ worked closely with Kennedy Clayton, the woodworkers, and the Army who erected the cross and acted as planning supervisor.

The ecumenical dedication service led by the Archbishop of Canterbury and the Archbishop of Westminster was attended by the Duke of York, who laid a bouquet at the foot of the cross.